

THIS DRAWING AND THE DATA DISCLOSED HEREIN OR HEREWITH IS NOT TO BE REPRODUCED USED OR DISCLOSED IN WHOLE OR IN PART TO ANYONE WITHOUT THE PERMISSION OF JESS-LINK PRODUCTS CO.,LTD.(JPC)

CUSTOMER DRAWING
DRWC-002229

REV.	ECN NO.	DESCRIPTION	MDF'D	APP'D	DATE
A1	---	INITIAL DESIGN	Pefer	Pefer	07/02/2020
A4	---	DELETE 3PIN,4PIN,5PIN AND ADD 25PIN,31PIN SPEC.	Chunxia	Andrew	10/10/2023
A5	---	ADD 5PIN SPEC.	Chunxia	Andrew	7/24/2025

$$S(\text{Eccentricity}) = |a-b|/2 < 0.05$$

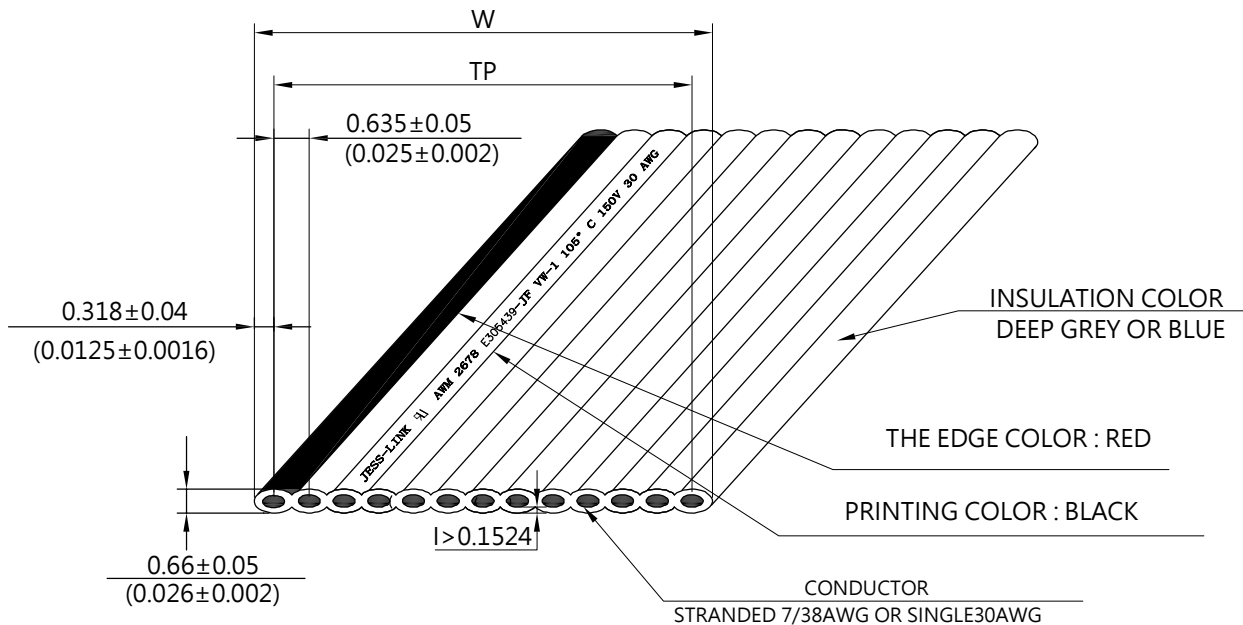
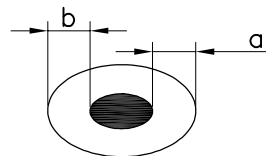

PRINTING:

- ① JESS-LINK AW AWM 2678 E305439-JF VW-1 105°C 150V 30 AWG
- ② NO PRINTING LESS THAN 9 CORES;NO EDGE MARKING LESS THAN 8 CORES

RoHS COMPLIANT	HALOGEN FREE	Unit : mm	PROJECTION	JPC connectivity		PD./FILE NO.
		GENERAL TOLERANCES: (UNLESS SPECIFIED)				---
		0 = ±.50	D.R. 7/24/2025	TITLE HM series 30AWG P=0.635	X-XXXX	
		0.0 = ±.25	Chunxia		REV. A5	
0.00 = ±.15	CH.K	SCALE	SIZE	PART NO.	SHEET 1 OF 3	
0.000 = ±.05	APV.D	NA	A4	PCB124234802-2		
0° = ± 2'						
0.0° = ± 1'						

THIS DRAWING AND THE DATA DISCLOSED HEREIN OR HEREWITH IS NOT TO BE REPRODUCED USED OR DISCLOSED IN WHOLE OR IN PART TO ANYONE WITHOUT THE PERMISSION OF JESS-LINK PRODUCTS CO.,LTD.(JPC)

CUSTOMER DRAWING
DRWC-002229

REV.	ECN NO.	DESCRIPTION	MDF'D	APP'D	DATE
A1	---	INITIAL DESIGN	Pefer	Pefer	07/02/2020
A4	---	DELETE 3PIN,4PIN,5PIN AND ADD 25PIN,31PIN SPEC.	Chunxia	Andrew	10/10/2023
A5	---	ADD 5PIN SPEC.	Chunxia	Andrew	7/24/2025

Couductor AWG	Material of Insulation	Insulation of Thickness	Spark Test	Dielectric Strength (1minute)	Couductor 20°C Resistance	Insulation Resistance	Impedance	Capacitance	Propagation Delay (REF.)	Insulation Color Pantone
							Different	Different		
							G-S-G(REF.)	G-S-G(REF.)		
Stranded 7/38 Tinned	PVC	Min 6mils	AC 1500V	AC 1500V	Max 376Ω/KM	Min 250MΩ/10FT	100±20Ω	64 PF/M	5.2 ns/M	430C
Single 30AWG BARE COPPER	PVC	Min 6mils	AC 1500V	AC 1500V	Max 361Ω /KM	Min 250MΩ/10FT	100±20Ω	58 PF/M	5.0 ns/M	427C
Single 30AWG Tinned Plated	PVC	Min 6mils	AC 1500V	AC 1500V	Max 361Ω /KM	Min 250MΩ/10FT	100±20Ω	58 PF/M	5.0 ns/M	430C

SPECIFICATIONS:
UL GRADE:
UL Style.....2678
Rate Temperature.....-20°C To 105°C
Rate Voltage.....150V
Flame Test.....VW-1
Max Electrcity:3A AT 25°C,50°C 75°C

RoHS COMPLIANT	HALOGEN FREE	Unit : mm	PROJECTION 	JPC connectivity			
		GENERAL TOLERANCES: (UNLESS SPECIFIED)	D.R. 7/24/2025 Chunxia			TITLE HM series 30AWG P=0.635	PD./FILE NO. ---
		0 = ±.50 0.0 = ±.25 0.00 = ±.15 0.000 = ±.05 0° = ± 2' 0.0° = ± 1'	CH.K	SCALE NA	SIZE A4	PART NO. PCB124234802-2	REV. A5
		APV.D			SHEET 2 OF 3		

1 2 3 4 5 6 7 8

THIS DRAWING AND THE DATA DISCLOSED HEREIN OR HEREWITH IS NOT TO BE REPRODUCED USED OR DISCLOSED IN WHOLE OR IN PART TO ANYONE WITHOUT THE PERMISSION OF JESS-LINK PRODUCTS CO.,LTD.(JPC)

CUSTOMER DRAWING
DRWC-002229

REV.	ECN NO.	DESCRIPTION	MDF'D	APP'D	DATE
A1	---	INITIAL DESIGN	Pefer	Pefer	07/02/2020
A4	---	DELETE 3PIN,4PIN,5PIN AND ADD 25PIN,31PIN SPEC.	Chunxia	Andrew	10/10/2023
A5	---	ADD 5PIN SPEC.	Chunxia	Andrew	7/24/2025



CODE NO.	NUMBER OF CORES	WIDTH(IN)	TP(IN)	S(mm)	l(mm)	ALLOWABLE ERROR mm
HM5	5	3.175(0.125±0.004)	2.54(0.1±0.004)	≤0.05	≥0.1524	±0.10
HM6	6	3.81(0.15±0.004)	3.175(0.125±0.004)	≤0.05	≥0.1524	±0.10
HM7	7	4.445(0.175±0.004)	3.81(0.15±0.004)	≤0.05	≥0.1524	±0.10
HM8	8	5.08(0.20±0.004)	4.445(0.175±0.004)	≤0.05	≥0.1524	±0.10
HM9	9	5.715(0.225±0.004)	5.08(0.2±0.004)	≤0.05	≥0.1524	±0.10
HM10	10	6.35(0.25±0.004)	5.715(0.225±0.004)	≤0.05	≥0.1524	±0.10
HM12	12	7.62(0.3±0.004)	6.985(0.275±0.004)	≤0.05	≥0.1524	±0.10
HM13	13	8.255(0.325±0.004)	7.62(0.3±0.004)	≤0.05	≥0.1524	±0.10
HM14	14	8.89(0.35±0.004)	8.255(0.325±0.004)	≤0.05	≥0.1524	±0.10
HM15	15	9.525(0.375±0.004)	8.89(0.35±0.004)	≤0.05	≥0.1524	±0.10
HM16	16	10.16(0.4±0.004)	9.525(0.375±0.004)	≤0.05	≥0.1524	±0.10
HM17	17	10.795(0.425±0.004)	10.16(0.4±0.004)	≤0.05	≥0.1524	±0.10
HM20	20	12.70(0.5±0.004)	12.065(0.475±0.004)	≤0.05	≥0.1524	±0.10
HM22	22	13.97(0.55±0.004)	13.335(0.525±0.004)	≤0.05	≥0.1524	±0.10
HM24	24	15.24(0.6±0.004)	14.605(0.575±0.004)	≤0.05	≥0.1524	±0.10
HM25	25	15.875(0.625±0.004)	15.24(0.6±0.004)	≤0.05	≥0.1524	±0.10
HM26	26	16.51(0.65±0.004)	15.875(0.625±0.004)	≤0.05	≥0.1524	±0.10
HM30	30	19.05(0.75±0.004)	18.415(0.725±0.004)	≤0.05	≥0.1524	±0.10
HM31	31	19.685(0.775±0.006)	19.05(0.750±0.006)	≤0.05	≥0.1524	±0.15
HM32	32	20.32(0.8±0.006)	19.685(0.775±0.006)	≤0.05	≥0.1524	±0.15
HM34	34	21.59(0.85±0.006)	20.955(0.825±0.006)	≤0.05	≥0.1524	±0.15
HM36	36	22.86(0.9±0.006)	22.225(0.875±0.006)	≤0.05	≥0.1524	±0.15
HM40	40	25.4(1.0±0.006)	24.765(0.975±0.006)	≤0.05	≥0.1524	±0.15
HM50	50	31.75(1.25±0.006)	31.115(1.225±0.006)	≤0.05	≥0.1524	±0.15
HM60	60	38.1(1.5±0.008)	37.465(1.475±0.008)	≤0.05	≥0.1524	±0.20
HM64	64	40.64(1.6±0.008)	40.005(1.575±0.008)	≤0.05	≥0.1524	±0.20
HM68	68	43.18(1.7±0.008)	42.545(1.675±0.008)	≤0.05	≥0.1524	±0.20
HM70	70	44.45(1.75±0.008)	43.815(1.725±0.008)	≤0.05	≥0.1524	±0.20
HM80	80	50.80(2.0±0.008)	50.165(1.975±0.008)	≤0.05	≥0.1524	±0.20
HM90	90	57.15(2.25±0.008)	56.515(2.225±0.008)	≤0.05	≥0.1524	±0.20
HM100	100	63.50(2.5±0.008)	62.865(2.475±0.008)	≤0.05	≥0.1524	±0.20

RoHS COMPLIANT	HALOGEN FREE	Unit : mm	PROJECTION 	JPC connectivity		PD./FILE NO.
		GENERAL TOLERANCES: (UNLESS SPECIFIED) 0 = ±.50 0.0 = ±.25 0.00 = ±.15 0.000 = ±.05 0" = ± .2" 0.0" = ± .1"	D.R. 7/24/2025 Chunxia			TITLE HM series 30AWG P=0.635
		CH.K	APV.D	SCALE NA	SIZE A4	PART NO. PCB124234802-2

1 2 3 4 5 6 7 8